

Lamp Troubleshooting Guide

Here are some quick troubleshooting tips for your Rear Projection TV (RPTV) lamp installation.

Common Issues:

After installation, lamp will not fire, ignite, or turn on

- Make sure the TV is plugged in and there is power going to the outlet
- Open the lamp door, reseal the lamp housing unit, then firmly close and secure the lamp door
- Reset lamp timer (if applicable)

Listen for sounds from your television, and check for indicator lights as there may be something else wrong with your TV. If there is no power to the unit at all, there may be a power supply issue. Other components like a defective color wheel or ballast can also cause TV malfunctions.

I see blinking indicator lights on the TV

A blinking indicator light, or series of lights, may be caused by other failed components and does not necessarily mean the lamp is bad. Please refer to your TV owner's manual for more information.

I hear a clicking noise or a low humming noise

The clicking or humming noise is most likely the ballast trying to power the lamp, but failing. This may indicate a defective ballast if you have recently purchased a new lamp. It's highly unlikely for a new lamp to be dead on arrival (DOA). A rapid, steady, or irregular clicking noise may also mean that the ballast isn't securely connected to the lamp.

I hear a whining, whirring, or screeching noise

(TVs using DLP technology only)

A loud whining, whirring, or screeching noise is most likely caused by a defective color wheel. Symptoms also include a dull, blurry, or distorted picture. A bad color wheel can also cause lamp indicator lights to blink and prevent the TV from powering on.

The lamp looks different than the original

You may have a newer designed lamp housing unit, lamp enclosure, or lamp. If the lamp unit does not fit properly into the TV, please contact the vendor for further investigation. It is possible that you may have ordered the wrong part. Some OEM parts may have changed slightly, and some aftermarket replacement parts may look different.

Digital Projection Lamp Installation & Troubleshooting Guide



Always be careful when servicing your TV. To reduce the risk of fire, electrical shock, and other injuries, practice safe methods when installing, using, and maintaining your unit. Fully read this guide before installing your lamp.



Risk of electric shock! It is recommended that you unplug your TV and ground yourself before installing or troubleshooting. Please refer to your original TV owner's manual for safety instructions.



Risk of fire! The high voltage components in your TV may cause a fire. When installing your lamp, make sure all connections are properly secure. Please refer to your original TV owner's manual for safety instructions.

Lamp Installation Guide

Installing the lamp housing unit or enclosure:

1

Make sure the TV is turned off, then unplug it. Locate the lamp door on your TV then open and remove it. The lamp door may be snapped into place or secured with screws. Please see your TV manual for details.

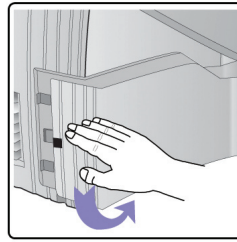
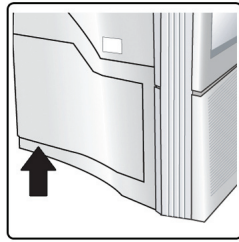
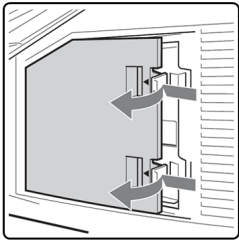

2

Uninstall the lamp unit from the television. Many times the lamp housing unit can be released by loosening screws then pulling the lamp straight out.

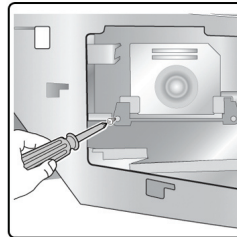

3

If you are replacing the bare lamp, stop here and continue with *Steps A-E* on the next page.

With the new lamp housing unit, reverse *Steps 1 and 2* to install it, then verify that the lamp unit is securely placed inside the television.

4

Make sure the lamp door is secure. Screw or snap panel door into place.

Turn the TV on and reset the lamp timer if necessary.

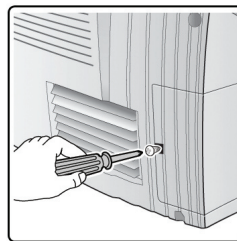

Reminder:

1. Turn the power off and wait for 30 minutes before replacing the lamp as it will be hot.
2. Do not touch the glass part of the lamp with your bare hands nor insert any foreign object inside the cover as it may cause poor screen quality, electric shock or fire.
3. Do not place the old lamp near flammable objects or within the reach of children.

Lamp Installation Guide

Installing the bare lamp:

A

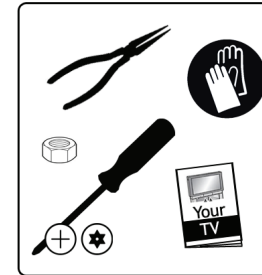

Make sure you have the proper tools for installation.

Most installations will require:

- latex gloves for safety
- a pair of pliers
- a screwdriver
- your television manual

B

Wear gloves. Remove screws or clips from the enclosure

C

Pull the enclosure open to expose the bare lamp

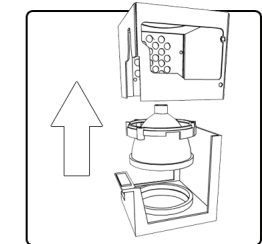
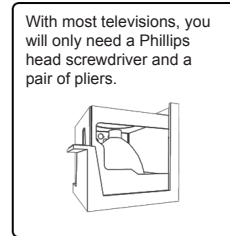

D

Remove the old lamp from the enclosure

E

Install the new lamp, then reverse steps to reassemble the enclosure

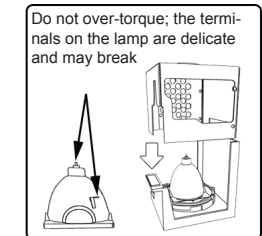
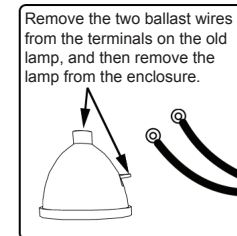

After installing the lamp, wipe off any smudges or fingerprints on the face of the lamp with a lint free cloth.

Continue with *Step 3* on the previous page.